

# Elbow 90°

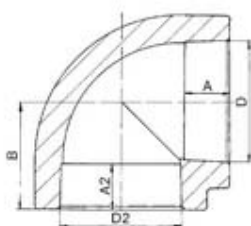

## Description

A simple, reliable fitting used to change the direction of a distribution system. When installed properly, it increases the pressure loss in the distribution system noticeably less than elbows in other distribution systems, thanks to the full-size inside diameter corresponding to that of the piping.



## Features List

								D, D1	D2	A	B	A2, C
16	pcs	400	50	0,01	0,03	202016	16		13,30	22,00		
20	pcs	300	50	0,02	0,07	202020	20		14,50	25,50		
25	pcs	200	50	0,03	0,12	202025	25		16,00	29,50		
32	pes	80	10	0,06	0,24	202032	32		18,10	35,00		
40	pcs	40	4	0,11	0,53	202040	40		20,50	41,50		
50	pcs	30	2	0,19	0,96	202050	50		23,50	49,50		
63	pcs	10	2	0,37	1,92	202063	63		27,40	60,00		
75	pes	6	1	0,52	3,20	202075	75		31,00	68,50		
90	pes	6	1	0,79	4,80	202090	90		35,50	79,00		
110	pcs	4	1	1,38	5,50	202110	110		41,50	93,00		